

MALTA TOWNSHIP SECTION 14 R-12 TWP-10 MORGAN COUNTY, OH

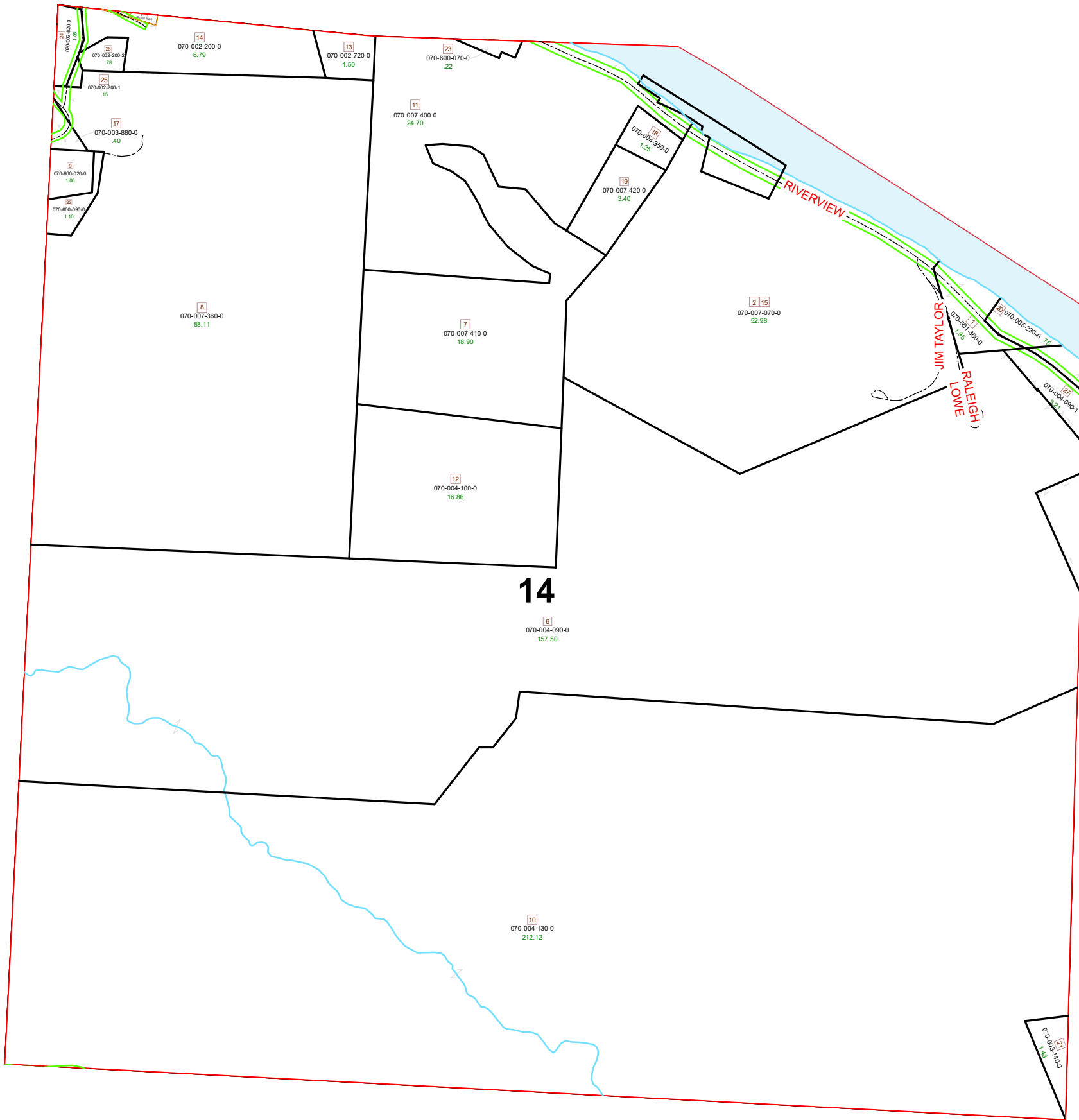

PIN	VOL	PAG	Owner	LegalDescr	Acres
080-005-600-0	D.V 201	304	BICKLEY JOHN R & HELEN D	PALACE HEIGHTS S	0
070-600-020-0	D.V 64	245	CEMETERY (MALTA UNION)	R12 T10 S14 LOT 17	2
070-001-360-0	OR125	483	DEAN GARY L & BARBARA L	R12 T10 S14 SD 1 S	1.95
070-005-230-0	OR33	155	FERGUSON THOMAS J	R12 T10 S14 SD 20	0.75
070-002-200-1	OR10	508	HALL CHARLES & KATHY	R12 T10 S14 SD 25	0.159
070-002-820-0	D.V 200	796	HALL CHARLES & KATHY	R12 T10 S14 SD 24	1.05
070-004-350-0	OR219	1034	HARMAN GREGORY H	R12 T10 S14 SD 18	1.25
070-003-140-0	OR21	502	HIPP LIMITED PARTNERSHIP	R12 T10 S14 SD 21	1.43
070-003-880-0	OR51	65	LAWRENCE STEVEN D	R12 T10 S14 SD 17	0.4
070-002-200-0	OR64	33	LEMON LISA A	R12 T10 S14 SD 14	6.797
070-004-090-1	OR218	1618	LOWE JEFFREY D & JULIA A CLEMENS	R12 T10 S14 SD 27	3.211
070-004-130-0	OR35	445	LOWE MICHAEL D & LORI SNYDER	R12 T10 S14 SD 10	212.12
070-600-090-0	D.V 139	235	MALTA TWP & MALTA VILLAGE UNION CEMETERY	R12 T10 S14 SD 22	1.1
070-004-100-0	OR203	518	MGF LAND CO LLC	R12 T10 S14 SD 12	16.86
070-004-090-0	OR203	518	MGF LAND CO LLC	R12 T10 S14 SD 6	157.509
070-600-070-0			MORGAN CO COMMISSIONERS	R12 T10 S14 SD 23	0.22
070-007-070-0	D.V 121	45	TAYLOR JAMES D & CARMEDE C	R12 T10 S14 SD 2-1	52.98
070-007-410-0	OR145	400	TOWNSEND A RANDALL & ROBIN L C/O A RANDALL	R12 T10 S14 SD 7	18.9
070-007-360-0	OR145	400	TOWNSEND A RANDALL & ROBIN L C/O A RANDALL	R12 T10 S14 SD 8	88.11
070-007-420-0	OR145	400	TOWNSEND A RANDALL & ROBIN L C/O A RANDALL	R12 T10 S14 SD 19	3.4
070-007-400-0	OR145	400	TOWNSEND A RANDALL & ROBIN L C/O A RANDALL	R12 T10 S14 SD 11	24.7
070-002-200-2	D.V 71	595	WEINER JAMIE MAE	R12 T10 S14 SD 26	0.788
070-002-720-0	OR232	4087	YOUNG CARRIE	R12 T10 S11 SEC 11	1.5

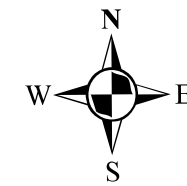

Boundaries	
----- Hidden	--- ROW
----- Hydro	--- Section
----- Roads	--- Lot
----- County	--- Township
----- Parcel	--- Parcels



Disclaimer: The information that these maps contains is for reference purposes only. Please bring any erros to the attention of the Engineer's Office staff.

Thank you